

Quick Set-up Guide

Complete User Guide at: <https://Caregiver247.sg>

Follow these steps and on-screen instructions



Caregiver24.7 App

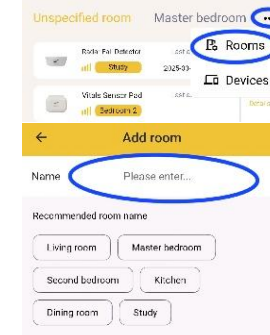
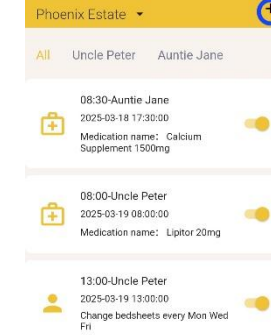
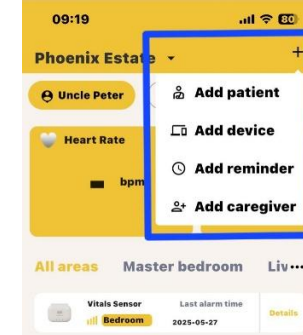
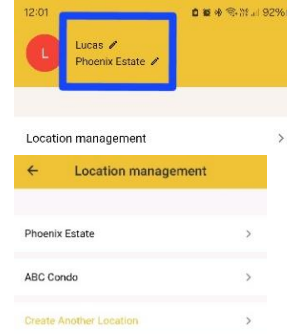

Vitals Sensor Pad

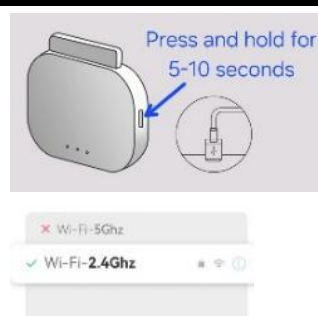
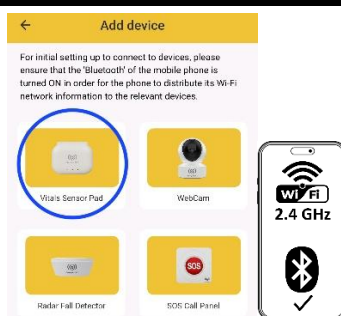

Initialization

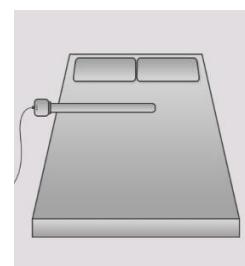

Calibration

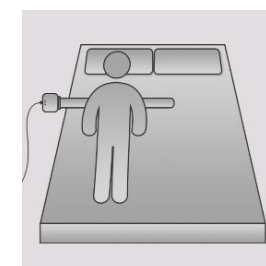

Bind device to designated patient and designate room deployed

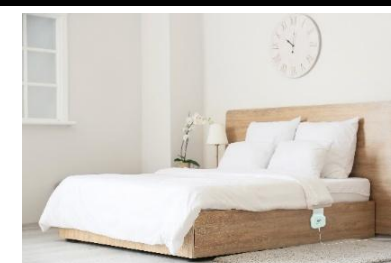
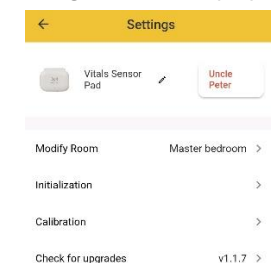

SOS Call Panel

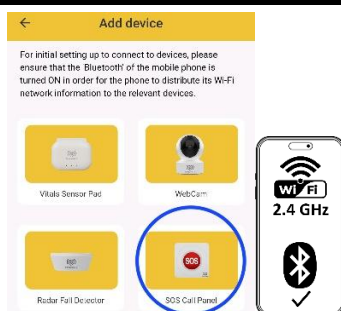

Designate room deployed

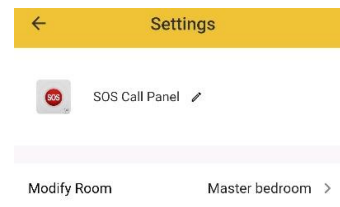

WebCam

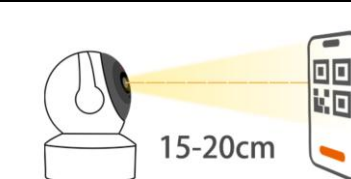
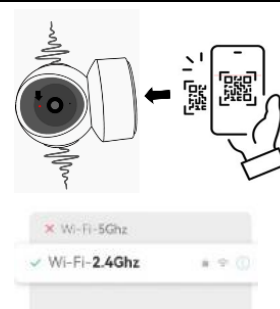
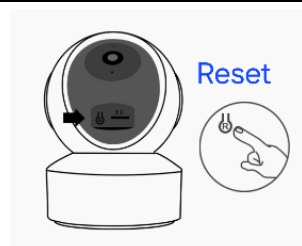
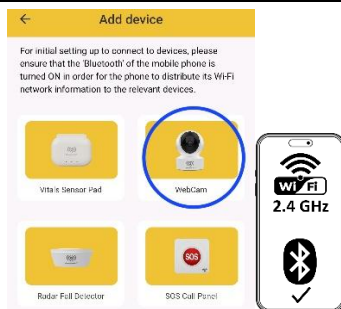

Designate room deployed

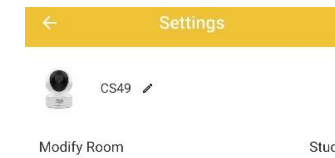

Radar Fall Detector

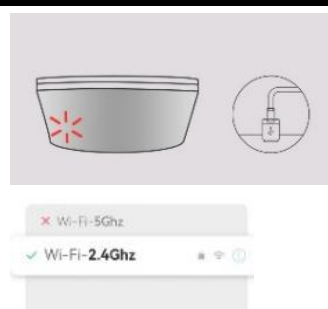

After successful Wi-Fi connection, wait for red indicator light to stabilize

Input installation height and designate room deployed

